

General Notes

- (i) Hard copies, dwf and pdf will form a controlled issue of the drawing. All other formats (dwg etc.) are deemed to be an uncontrolled issue and any work carried out based on these files is at the recipient's own risk. RPS will not accept any responsibility for any errors from the use of these files, either by human error by the recipient, listing of the un-dimensioned measurements, compatibility with the recipient's software, and any errors arising when these files are used to aid the recipient's drawing production, or setting out on site.
- (ii) DO NOT SCALE, use figured dimensions only.
- (iii) This drawing is the property of RPS, it is a project confidential classified document. It must not be copied used or its contents divulged without prior written consent. The needs and expectations of client and RPS must be considered when working with this drawing.
- (iv) Information including topographical survey, geotechnical investigation and utility detail used in the design have been provided by others.
- (v) All Levels refer to Ordnance Survey Datum, Main Head.

Rev	Date	Drawn	Checked	Amendment / Issue	App
S4 P01	08/06/22	PKR	DMK	Issued for Planning	PKR
S3 P03	08/06/22	PKR	DMK	Issue for Review and Comment	PKR
P01	26/10/21	PKR	DMK	Pre-Application Submission	PKR















Model File Identifier
MCW1088-RPS-00-XX-DR-C-UT0101

Scale: 1:2000 @ A1
1:4000 @ A3
Created on: 13/09/2021
Sheets: 01 of 09

Client	Project	Status	Rev
	Castlelake SHD	S4	P01
Title		Proposed Watermain Infrastructure Key Plan	
File Identifier		MCW1088-RPS-00-XX-DR-C-UT0101-01	

LEGEND:

-  Existing Watermains
-  Existing Watermains to be Decommissioned
-  Proposed DN180 SDR17 PE100 Watermains
-  Proposed 100mm dia Water Connection
-  Proposed Sluice Valve
-  Proposed Hydrant
-  Proposed Air Valve
-  Proposed Scour Valve
-  Proposed Washout Hydrant
-  Proposed Boundary Box
-  Proposed Bulk Meter
-  Proposed Manifold with Individual Meters

WATERMAIN NOTES:
 1. BULK METERS TO BE PROVIDED (BY DEVELOPER) FOR EACH NEW DEVELOPMENT, IN ACCORDANCE WITH STD-W-02 & STD-W-26A.
 2. ALL CHAMBERS TO BE CONSTRUCTED IN ACCORDANCE WITH HW-CDS-5020-26.
 3. THRUST / SUPPORT BLOCKS TO BE LOCATED ON BENDS AND T JUNCTIONS AND AS REQUIRED, BASED ON STD-W-28.
 4. WHERE POSSIBLE, WATERMAINS TO HAVE A MINIMUM 300mm VERTICAL AND HORIZONTAL CLEARANCE TO ALL OTHER SERVICES.
 5. PROPOSED SLUICE VALVES IN ACCORDANCE WITH STD-W-15.
 6. PROPOSED AIR VALVES IN ACCORDANCE WITH STD-W-22.
 7. WHERE MINIMUM PIPE COVER CANNOT BE ACHIEVED, CONCRETE SURROUND TO GRADE C25/30 IS REQUIRED AS PER DIMENSIONS SPECIFIED IN STD-W-31.



PROPOSED BOUNDARY BOX ON SERVICE CONNECTION TO EACH DWELLING Ref. STD-W-03

PROPOSED WATERMAIN NETWORK SHOWN THUS

EXISTING WATERMAIN NETWORK SHOWN THUS

PROPOSED BOUNDARY BOX ON SERVICE CONNECTION TO EACH DWELLING Ref. STD-W-03

WASHOUT HYDRANT TO STD-W-30A (REQUIRED SLUICE VALVE NOT SHOWN FOR CLARITY)

WASHOUT HYDRANT TO STD-W-30A (REQUIRED SLUICE VALVE NOT SHOWN FOR CLARITY)

WASHOUT HYDRANT TO STD-W-30A (REQUIRED SLUICE VALVE NOT SHOWN FOR CLARITY)

PROPOSED BOUNDARY BOX ON SERVICE CONNECTION TO EACH DWELLING Ref. STD-W-03

OFF-LINE SCOUR VALVE CONNECTED TO STORM MANHOLE TO STD-W-30 (REQUIRED SLUICE VALVE NOT SHOWN FOR CLARITY)

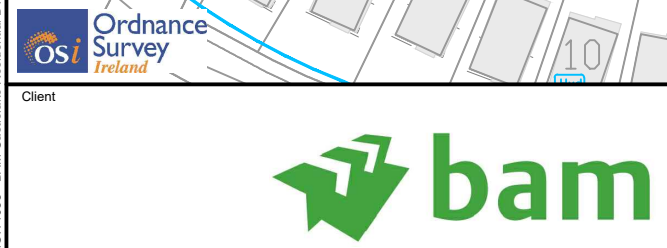

General Notes

(i) Hard copies, dwf and pdf will form a controlled issue of the drawing. All other formats (dwg etc.) are deemed to be an uncontrolled issue and any work carried out based on these files is at the recipient's own risk. RPS will not accept any responsibility for any errors from the use of these files, either by human error by the recipient, listing of the un-dimensioned measurements, compatibility with the recipient's software, and any errors arising when these files are used to aid the recipient's drawing production, or setting out on site.

(ii) DO NOT SCALE, use figured dimensions only.

(iii) This drawing is the property of RPS, it is a project confidential classified document. It must not be copied used or its contents divulged without prior written consent. The needs and expectations of client and RPS must be considered when working with this drawing.

(iv) Information including topographical survey, geotechnical investigation and utility detail used in the design have been provided by others.

(v) All Levels refer to Ordnance Survey Datum, Main Head.

Rev	Date	Dim Chk	Amendment / Issue	App
S4 P01	08/06/22		Issued for Planning	
S3 P03	08/06/22		Issue for Review and Comment	
P01	29/10/21		Pre-Application Submission	



Scale	1:500 @ A1 1:1000 @ A3	Project	Castlelake SHD
Created on	13/09/2021	Title	Proposed Watermain Infrastructure Watermain Layout (1 of 8)
Sheets	02 of 09	File Identifier	MCW1088-RPS-00-XX-DR-C-UT0101-02
Model File Identifier	MCW1088-RPS-00-XX-DR-C-UT0101	Status	S4
Rev	P01	Rev	P01

R:\MCW1088 - BAM Castlelake Residential Dwg18.d Drawings\UT\MCW1088-RPS-00-XX-DR-C-UT0101.dwg

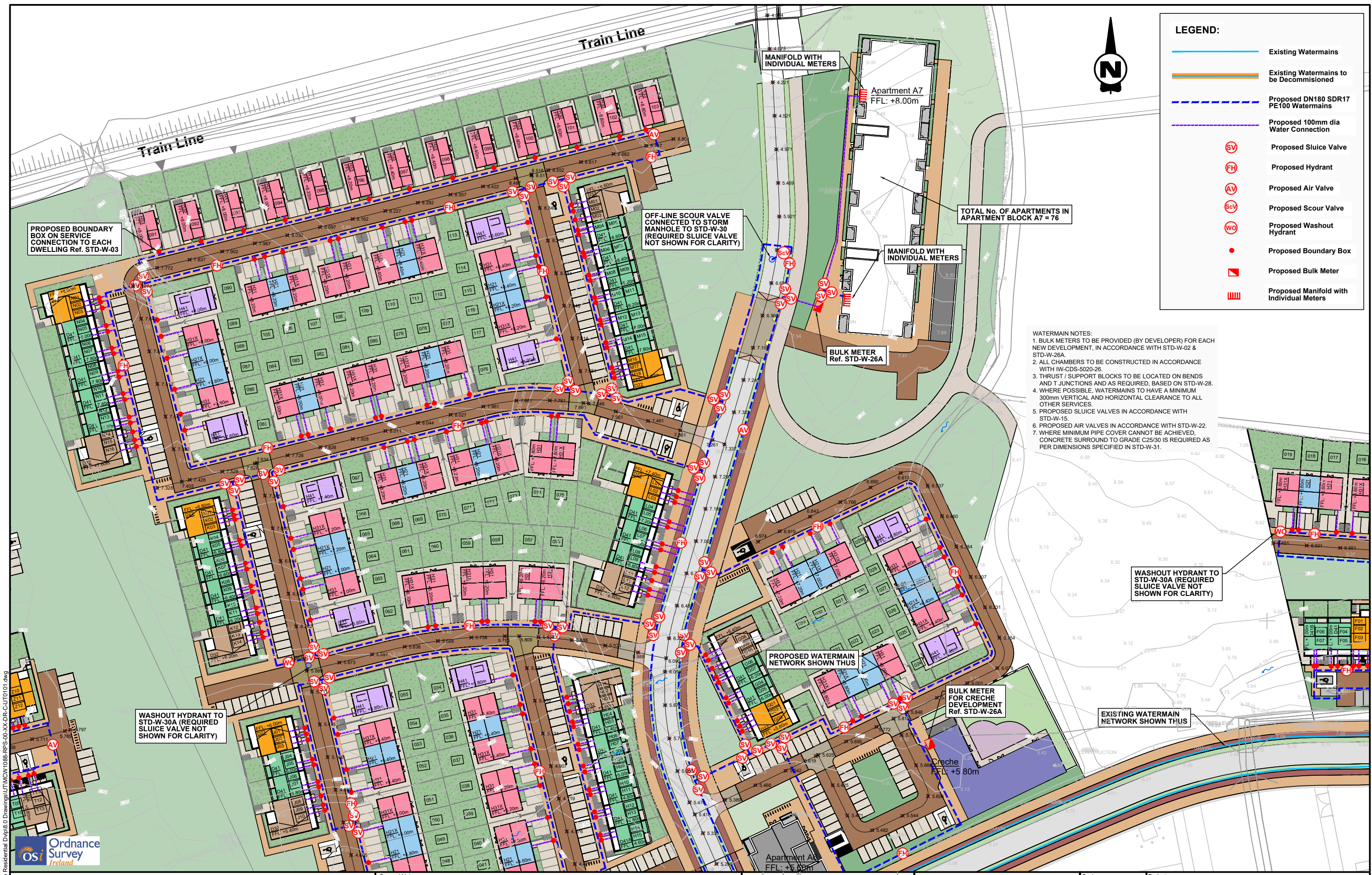

LEGEND:

- Existing Watermains
- Existing Watermains to be Decommissioned
- Proposed DN180 SDR17 PE100 Watermains
- Proposed 100mm dia Water Connection
- SV Proposed Sluice Valve
- FH Proposed Hydrant
- AV Proposed Air Valve
- ScV Proposed Scour Valve
- WC Proposed Washout Hydrant
- Proposed Boundary Box
- Proposed Bulk Meter
- ▩ Proposed Manifold with Individual Meters

WATERMAIN NOTES:

- BULK METERS TO BE PROVIDED (BY DEVELOPER) FOR EACH NEW DEVELOPMENT, IN ACCORDANCE WITH STD-W-02 & STD-W-26A.
- ALL CHAMBERS TO BE CONSTRUCTED IN ACCORDANCE WITH IW-CDS-5020-26.
- THRUST / SUPPORT BLOCKS TO BE LOCATED ON BENDS AND T JUNCTIONS AND AS REQUIRED, BASED ON STD-W-28.
- WHERE POSSIBLE, WATERMAINS TO HAVE A MINIMUM 300mm VERTICAL AND HORIZONTAL CLEARANCE TO ALL OTHER SERVICES.
- PROPOSED SLUICE VALVES IN ACCORDANCE WITH STD-W-15.
- PROPOSED AIR VALVES IN ACCORDANCE WITH STD-W-22.
- WHERE MINIMUM PIPE COVER CANNOT BE ACHIEVED, CONCRETE SURROUND TO GRADE C25/30 IS REQUIRED AS PER DIMENSIONS SPECIFIED IN STD-W-31.

PROPOSED BOUNDARY BOX ON SERVICE CONNECTION Ref. STD-W-03

OFF-LINE SCOUR VALVE CONNECTED TO STORM MANHOLE TO STD-W-30 (REQUIRED SLUICE VALVE NOT SHOWN FOR CLARITY)

TOTAL No. OF APARTMENTS IN APARTMENT BLOCK A7 = 76

MANIFOLD WITH INDIVIDUAL METERS

MANIFOLD WITH INDIVIDUAL METERS

BULK METER Ref. STD-W-26A

PROPOSED WATERMAIN NETWORK SHOWN THIS

BULK METER FOR CRECHE DEVELOPMENT Ref. STD-W-26A

WASHOUT HYDRANT TO STD-W-30A (REQUIRED SLUICE VALVE NOT SHOWN FOR CLARITY)

WASHOUT HYDRANT TO STD-W-30A (REQUIRED SLUICE VALVE NOT SHOWN FOR CLARITY)

EXISTING WATERMAIN NETWORK SHOWN THIS

Client: **Ordnance Survey Ireland**

bam

Ordnance Survey Ireland Licence No. CYAL50173842 © Ordnance Survey Ireland/Government of Ireland

General Notes

(i) Hard copies, dwf and pdf will form a controlled issue of the drawing. All other formats (dwg etc.) are deemed to be an uncontrolled issue and any work carried out based on these files is at the recipient's own risk. RPS will not accept any responsibility for any errors from the use of these files, either by human error by the recipient, listing of the un-dimensioned measurements, compatibility with the recipient's software, and any errors arising when these files are used to aid the recipient's drawing production, or setting out on site.

(ii) DO NOT SCALE, use figured dimensions only.

(iii) This drawing is the property of RPS, it is a project confidential classified document. It must not be copied used or its contents divulged without prior written consent. The needs and expectations of client and RPS must be considered when working with this drawing.

(iv) Information including topographical survey, geotechnical investigation and utility detail used in the design have been provided by others.

(v) All Levels refer to Ordnance Survey Datum, Main Head.

Rev	Date	Dim Chk	Amendment / Issue	App
S4 P01	08/06/22	PER	Issued for Planning	DB
S3 P03	08/06/22	PER	Issue for Review and Comment	DB
P01	29/10/21	PER	Pre-Application Submission	DB

RPS

Model File Identifier: **MCW1088-RPS-00-XX-DR-C-UT0101**

Scale: 1:500 @ A1 1:1000 @ A3	Project: Castlelake SHD
Created on: 13/09/2021	Title: Proposed Watermain Infrastructure Watermain Layout (2 of 8)
Sheets: 03 of 09	File Identifier: MCW1088-RPS-00-XX-DR-C-UT0101-03
Status: S4	Rev: P01

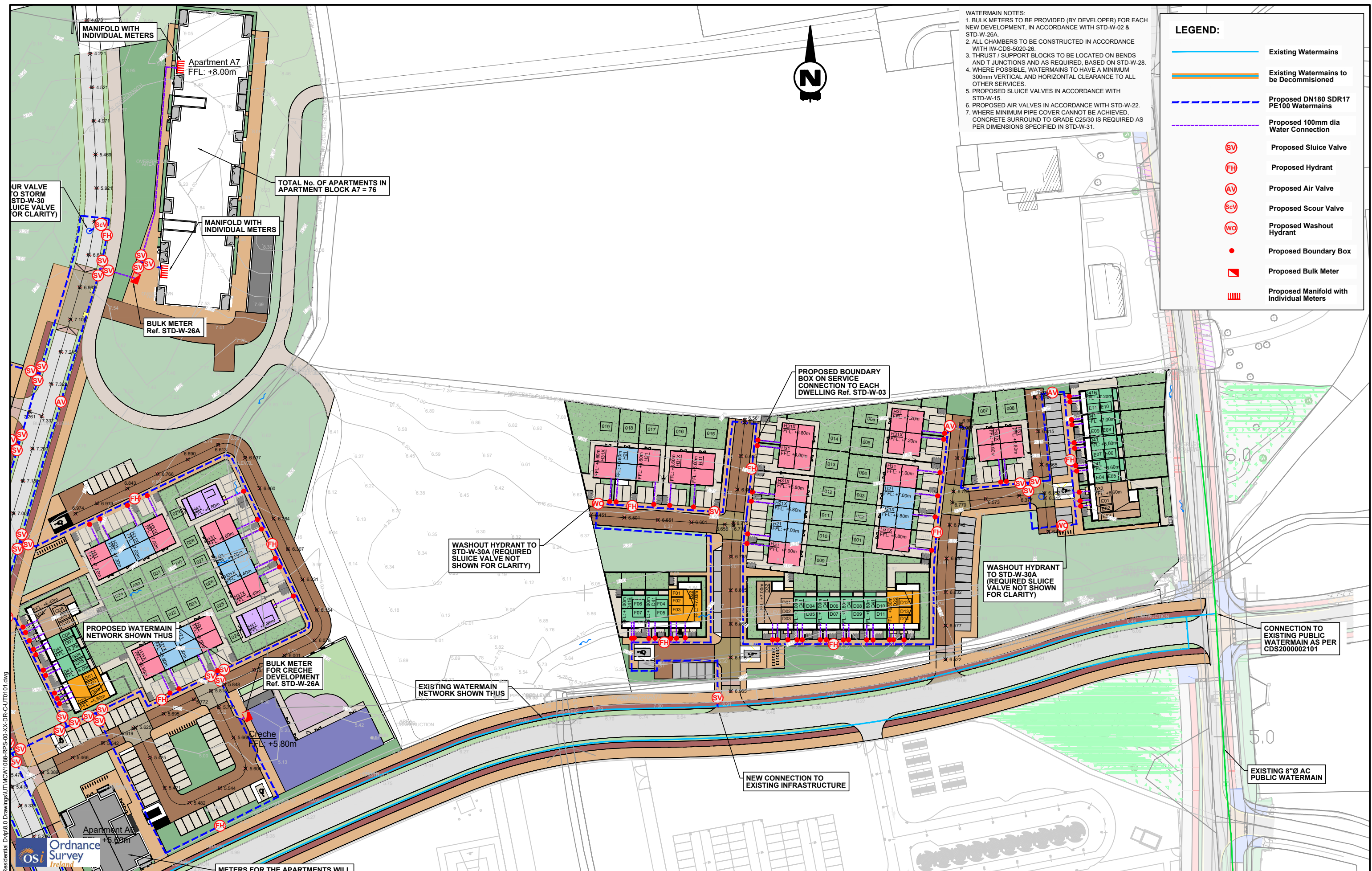

- WATERMAIN NOTES:**
1. BULK METERS TO BE PROVIDED (BY DEVELOPER) FOR EACH NEW DEVELOPMENT, IN ACCORDANCE WITH STD-W-02 & STD-W-26A.
 2. ALL CHAMBERS TO BE CONSTRUCTED IN ACCORDANCE WITH IW-CDS-5020-26.
 3. THRUST / SUPPORT BLOCKS TO BE LOCATED ON BENDS AND T JUNCTIONS AND AS REQUIRED, BASED ON STD-W-28.
 4. WHERE POSSIBLE, WATERMAINS TO HAVE A MINIMUM 300mm VERTICAL AND HORIZONTAL CLEARANCE TO ALL OTHER SERVICES.
 5. PROPOSED SLUICE VALVES IN ACCORDANCE WITH STD-W-15.
 6. PROPOSED AIR VALVES IN ACCORDANCE WITH STD-W-22.
 7. WHERE MINIMUM PIPE COVER CANNOT BE ACHIEVED, CONCRETE SURROUND TO GRADE C25/30 IS REQUIRED AS PER DIMENSIONS SPECIFIED IN STD-W-31.

LEGEND:

- Existing Watermains
- Existing Watermains to be Decommissioned
- Proposed DN180 SDR17 PE100 Watermains
- Proposed 100mm dia Water Connection
- SV Proposed Sluice Valve
- FH Proposed Hydrant
- AV Proposed Air Valve
- ScV Proposed Scour Valve
- WC Proposed Washout Hydrant
- Proposed Boundary Box
- Proposed Bulk Meter
- ▤ Proposed Manifold with Individual Meters

R:\MCW1088 - B&M Castlelake Residential Dupl\8.0 Drawings\UT\MCW1088-RPS-00-XX-DR-C-UT0101.dwg

Client: **Ordnance Survey Ireland**

bam

METERS FOR THE APARTMENTS WILL

General Notes

(i) Hard copies, dwf and pdf will form a controlled issue of the drawing. All other formats (dwg etc.) are deemed to be an uncontrolled issue and any work carried out based on these files is at the recipient's own risk. RPS will not accept any responsibility for any errors from the use of these files, either by human error by the recipient, listing of the un-dimensioned measurements, compatibility with the recipient's software, and any errors arising when these files are used to aid the recipient's drawing production, or setting out on site.

(ii) DO NOT SCALE, use figured dimensions only.

(iii) This drawing is the property of RPS, it is a project confidential classified document. It must not be copied used or its contents divulged without prior written consent. The needs and expectations of client and RPS must be considered when working with this drawing.

(iv) Information including topographical survey, geotechnical investigation and utility detail used in the design have been provided by others.

(v) All Levels refer to Ordnance Survey Datum, Main Head.

Rev	Date	Dim Chk	Amendment / Issue	App
S4 P01	08/06/22	RPS	Issued for Planning	
S3 P03	08/06/22	RPS	Issue for Review and Comment	
P01	29/10/21	RPS	Pre-Application Submission	

rps

Model File Identifier: **MCW1088-RPS-00-XX-DR-C-UT0101**

Scale: 1:500 @ A1 1:1000 @ A3	Project: Castlelake SHD
Created on: 13/09/2021	Title: Proposed Watermain Infrastructure Watermain Layout (3 of 8)
Sheets: 04 of 09	Status: S4 Rev: P01
File Identifier: MCW1088-RPS-00-XX-DR-C-UT0101-04	

LEGEND:

- Existing Watermains
- Existing Watermains to be Decommissioned
- - - Proposed DN180 SDR17 PE100 Watermains
- - - Proposed 100mm dia Water Connection
- SV Proposed Sluice Valve
- FH Proposed Hydrant
- AV Proposed Air Valve
- ScV Proposed Scour Valve
- WO Proposed Washout Hydrant
- Proposed Boundary Box
- Proposed Bulk Meter
- ▤ Proposed Manifold with Individual Meters

WATERMAIN NOTES:

1. BULK METERS TO BE PROVIDED (BY DEVELOPER) FOR EACH NEW DEVELOPMENT, IN ACCORDANCE WITH STD-W-02 & STD-W-26A.
2. ALL CHAMBERS TO BE CONSTRUCTED IN ACCORDANCE WITH IW-CDS-5020-26.
3. THRUST / SUPPORT BLOCKS TO BE LOCATED ON BENDS AND T-JUNCTIONS AND AS REQUIRED, BASED ON STD-W-28.
4. WHERE POSSIBLE, WATERMAINS TO HAVE A MINIMUM 300mm VERTICAL AND HORIZONTAL CLEARANCE TO ALL OTHER SERVICES.
5. PROPOSED SLUICE VALVES IN ACCORDANCE WITH STD-W-15.
6. PROPOSED AIR VALVES IN ACCORDANCE WITH STD-W-22.
7. WHERE MINIMUM PIPE COVER CANNOT BE ACHIEVED, CONCRETE SURROUND TO GRADE C25/30 IS REQUIRED AS PER DIMENSIONS SPECIFIED IN STD-W-31.

WASHOUT HYDRANT TO STD-W-30A (REQUIRED SLUICE VALVE NOT SHOWN FOR CLARITY)

PROPOSED BOUNDARY BOX ON SERVICE CONNECTION TO EACH DWELLING Ref. STD-W-03

OFF-LINE SCOUR VALVE CONNECTED TO STORM MANHOLE TO STD-W-30 (REQUIRED SLUICE VALVE NOT SHOWN FOR CLARITY)

NEW CONNECTION TO EXISTING INFRASTRUCTURE

OFF-LINE SCOUR VALVE CONNECTED TO STORM MANHOLE TO STD-W-30 (REQUIRED SLUICE VALVE NOT SHOWN FOR CLARITY)

PROPOSED WATERMAIN NETWORK SHOWN THUS

METERS TO BE INSTALLED THE PRELIMINARY CONTROL REQUIREMENTS REVIEW BY TOTAL NO.

NEW CONNECTION TO EXISTING INFRASTRUCTURE

PROPOSED BOUNDARY BOX ON SERVICE CONNECTION TO EACH DWELLING Ref. STD-W-03

EXISTING WATERMAIN NETWORK SHOWN THUS

PROPOSED BOUNDARY BOX ON SERVICE CONNECTION TO EACH DWELLING Ref. STD-W-03

PROPOSED WATERMAIN NETWORK SHOWN THUS

MANIFOLD WITH INDIVIDUAL METERS

Apartment A2
FFL: +3.75m

NEW CONNECTION TO EXISTING INFRASTRUCTURE

BULK METER
Ref. STD-W-26A

TOTAL No. OF APARTMENTS IN APARTMENT BLOCK A2 = 42



General Notes

- (i) Hard copies, dwf and pdf will form a controlled issue of the drawing. All other formats (dwg etc.) are deemed to be an uncontrolled issue and any work carried out based on these files is at the recipient's own risk. RPS will not accept any responsibility for any errors from the use of these files, either by human error by the recipient, listing of the un-dimensioned measurements, compatibility with the recipient's software, and any errors arising when these files are used to aid the recipient's drawing production, or setting out on site.
- (ii) DO NOT SCALE, use figured dimensions only.
- (iii) This drawing is the property of RPS, it is a project confidential document. It must not be copied used or its contents divulged without prior written consent. The needs and expectations of client and RPS must be considered when working with this drawing.
- (iv) Information including topographical survey, geotechnical investigation and utility detail used in the design have been provided by others.
- (v) All Levels refer to Ordnance Survey Datum, Main Head.

Rev	Date	Drawn	Amendment / Issue	App
S4 P01	08/06/22	PER	Issued for Planning	
S3 P03	08/06/22	PER	Issue for Review and Comment	
P01	26/10/21	PER	Pre-Application Submission	



Model File Identifier
MCW1088-RPS-00-XX-DR-C-UT0101

Scale
1:500 @ A1
1:1000 @ A3

Created on
13/09/2021

Sheets
05 of 09

Project	Castlelake SHD
Title	Proposed Watermain Infrastructure Watermain Layout (4 of 8)
File Identifier	MCW1088-RPS-00-XX-DR-C-UT0101-05
Status	S4
Rev	P01

R:\MCW1088 - BAM Castlelake Residential Dwp18.0 Drawings\UT\MCW1088-RPS-00-XX-DR-C-UT0101.dwg

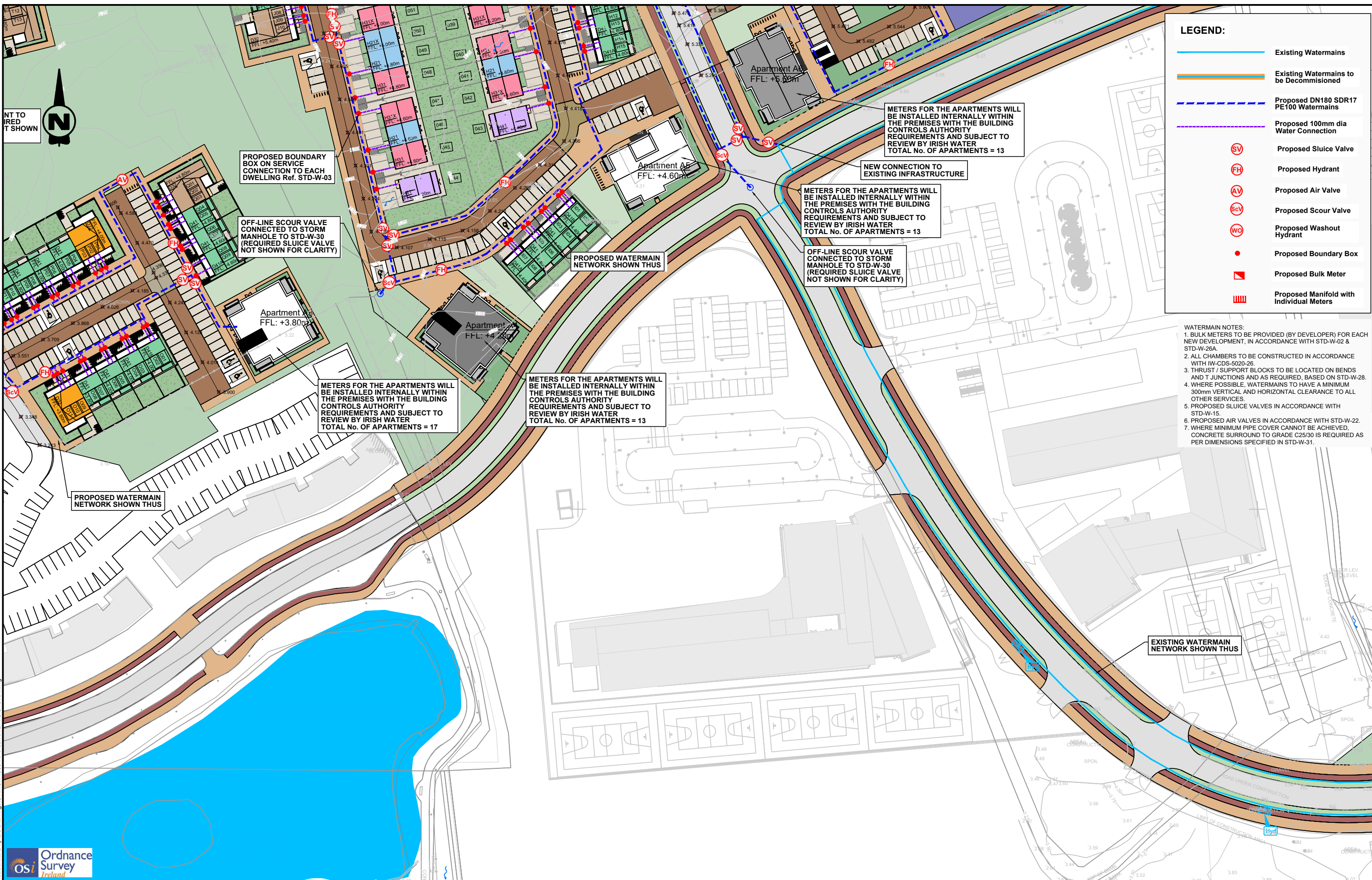

LEGEND:

- Existing Watermains
- Existing Watermains to be Decommissioned
- Proposed DN180 SDR17 PE100 Watermains
- Proposed 100mm dia Water Connection
- SV Proposed Sluice Valve
- FH Proposed Hydrant
- AV Proposed Air Valve
- ScV Proposed Scour Valve
- WG Proposed Washout Hydrant
- Proposed Boundary Box
- Proposed Bulk Meter
- ▨ Proposed Manifold with Individual Meters

- WATERMAIN NOTES:**
1. BULK METERS TO BE PROVIDED (BY DEVELOPER) FOR EACH NEW DEVELOPMENT, IN ACCORDANCE WITH STD-W-02 & STD-W-26A.
 2. ALL CHAMBERS TO BE CONSTRUCTED IN ACCORDANCE WITH IW-CDS-5020-26.
 3. THRUST / SUPPORT BLOCKS TO BE LOCATED ON BENDS AND T JUNCTIONS AND AS REQUIRED, BASED ON STD-W-28.
 4. WHERE POSSIBLE, WATERMAINS TO HAVE A MINIMUM 300mm VERTICAL AND HORIZONTAL CLEARANCE TO ALL OTHER SERVICES.
 5. PROPOSED SLUICE VALVES IN ACCORDANCE WITH STD-W-15.
 6. PROPOSED AIR VALVES IN ACCORDANCE WITH STD-W-22.
 7. WHERE MINIMUM PIPE COVER CANNOT BE ACHIEVED, CONCRETE SURROUND TO GRADE C25/30 IS REQUIRED AS PER DIMENSIONS SPECIFIED IN STD-W-31.



Client
 General Notes
 (i) Hard copies, dwf and pdf will form a controlled issue of the drawing. All other formats (dwg etc.) are deemed to be an uncontrolled issue and any work carried out based on these files is at the recipient's own risk. RPS will not accept any responsibility for any errors from the use of these files, either by human error or by the recipient, listing of the un-dimensioned measurements, compatibility with the recipient's software, and any errors arising when these files are used to aid the recipient's drawing production, or setting out on site.
 (ii) DO NOT SCALE, use figured dimensions only.

(iii) This drawing is the property of RPS, it is a project confidential classified document. It must not be copied used or its contents divulged without prior written consent. The needs and expectations of client and RPS must be considered when working with this drawing.
 (iv) Information including topographical survey, geotechnical investigation and utility detail used in the design have been provided by others.
 (v) All Levels refer to Ordnance Survey Datum, Main Head.

Rev	Date	Dim Chk	Amendment / Issue	App
S4	08/06/22	PKR	Issued for Planning	PKR
S3	08/06/22	PKR	Issue for Review and Comment	PKR
P01	29/10/21	PKR	Pre-Application Submission	PKR

RPS

Model File Identifier
 MCW1088-RPS-00-XX-DR-C-UT0101

Scale 1:500 @ A1 1:1000 @ A3	Project Castlelake SHD
Created on 13/09/2021	Title Proposed Watermain Infrastructure Watermain Layout (5 of 8)
Sheets 06 of 09	Status S4
File Identifier MCW1088-RPS-00-XX-DR-C-UT0101-06	Rev P01

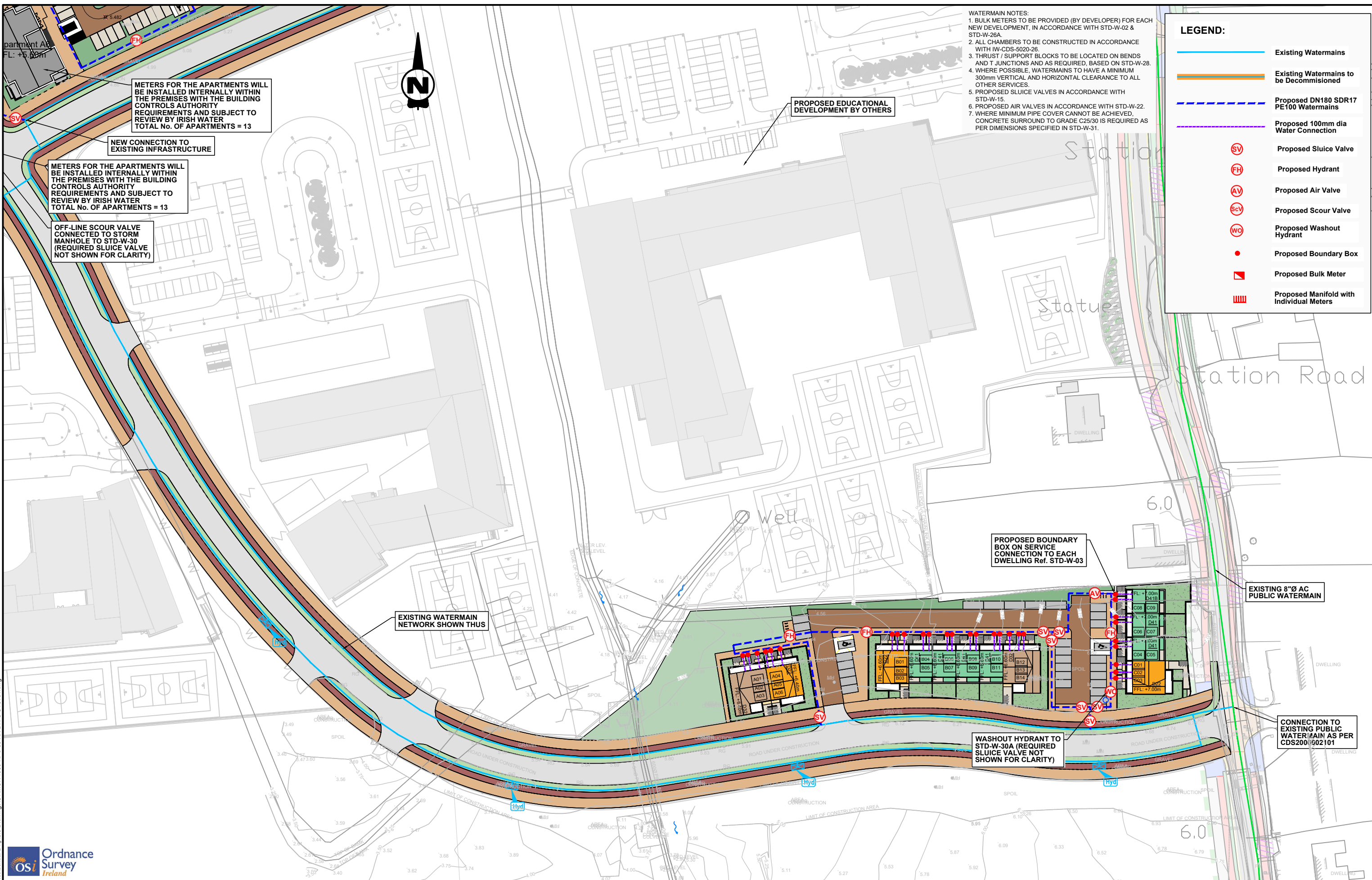

- WATERMAIN NOTES:**
1. BULK METERS TO BE PROVIDED (BY DEVELOPER) FOR EACH NEW DEVELOPMENT, IN ACCORDANCE WITH STD-W-02 & STD-W-26A.
 2. ALL CHAMBERS TO BE CONSTRUCTED IN ACCORDANCE WITH IW-CDS-5020-26.
 3. THRUST / SUPPORT BLOCKS TO BE LOCATED ON BENDS AND T JUNCTIONS AND AS REQUIRED, BASED ON STD-W-28.
 4. WHERE POSSIBLE, WATERMANS TO HAVE A MINIMUM 300mm VERTICAL AND HORIZONTAL CLEARANCE TO ALL OTHER SERVICES.
 5. PROPOSED SLUICE VALVES IN ACCORDANCE WITH STD-W-15.
 6. PROPOSED AIR VALVES IN ACCORDANCE WITH STD-W-22.
 7. WHERE MINIMUM PIPE COVER CANNOT BE ACHIEVED, CONCRETE SURROUND TO GRADE C25/30 IS REQUIRED AS PER DIMENSIONS SPECIFIED IN STD-W-31.

LEGEND:

- Existing Watermains
- Existing Watermains to be Decommissioned
- Proposed DN180 SDR17 PE100 Watermains
- Proposed 100mm dia Water Connection
- Proposed Sluice Valve (SV)
- Proposed Hydrant (FH)
- Proposed Air Valve (AV)
- Proposed Scour Valve (ScV)
- Proposed Washout Hydrant (WO)
- Proposed Boundary Box
- Proposed Bulk Meter
- Proposed Manifold with Individual Meters

METERS FOR THE APARTMENTS WILL BE INSTALLED INTERNALLY WITHIN THE PREMISES WITH THE BUILDING CONTROLS AUTHORITY REQUIREMENTS AND SUBJECT TO REVIEW BY IRISH WATER TOTAL No. OF APARTMENTS = 13

METERS FOR THE APARTMENTS WILL BE INSTALLED INTERNALLY WITHIN THE PREMISES WITH THE BUILDING CONTROLS AUTHORITY REQUIREMENTS AND SUBJECT TO REVIEW BY IRISH WATER TOTAL No. OF APARTMENTS = 13

OFF-LINE SCOUR VALVE CONNECTED TO STORM MANHOLE TO STD-W-30 (REQUIRED SLUICE VALVE NOT SHOWN FOR CLARITY)

PROPOSED EDUCATIONAL DEVELOPMENT BY OTHERS

PROPOSED BOUNDARY BOX ON SERVICE CONNECTION TO EACH DWELLING Ref. STD-W-03

EXISTING WATERMAIN NETWORK SHOWN THUS

WASHOUT HYDRANT TO STD-W-30A (REQUIRED SLUICE VALVE NOT SHOWN FOR CLARITY)

EXISTING 8"Ø AC PUBLIC WATERMAIN

CONNECTION TO EXISTING PUBLIC WATERMAIN AS PER CDS200/002101



General Notes

(i) Hard copies, dwf and pdf will form a controlled issue of the drawing. All other formats (dwg etc.) are deemed to be an uncontrolled issue and any work carried out based on these files is at the recipients own risk. RPS will not accept any responsibility for any errors from the use of these files, either by human error by the recipient, listing of the un-dimensioned measurements, compatibility with the recipients software, and any errors arising when these files are used to aid the recipients drawing production, or setting out on site.

(ii) DO NOT SCALE, use figured dimensions only.

(iii) This drawing is the property of RPS, it is a project confidential classified document. It must not be copied used or its contents divulged without prior written consent. The needs and expectations of client and RPS must be considered when working with this drawing.

(iv) Information including topographical survey, geotechnical investigation and utility detail used in the design have been provided by others.

(v) All Levels refer to Ordnance Survey Datum, Main Head.

Rev	Date	Dim Chk	Amendment / Issue	App
S4 P01	08/06/22	PER RPS	Issued for Planning	
S3 P03	08/06/22	PER RPS	Issue for Review and Comment	
P01	26/10/21	PER RPS	Pre-Application Submission	

RPS

Model File Identifier
MCW1088-RPS-00-XX-DR-C-UT0101

Scale	1:500 @ A1 1:1000 @ A3	Project	Castlelake SHD
Created on	13/09/2021	Title	Proposed Watermain Infrastructure Watermain Layout (6 of 8)
Sheets	07 of 09	Status	S4
File Identifier	MCW1088-RPS-00-XX-DR-C-UT0101-07	Rev	P01

R:\MCW1088 - BAM Castlelake Residential Dwp18.0 Drawings\UT\MCW1088-RPS-00-XX-DR-C-UT0101.dwg

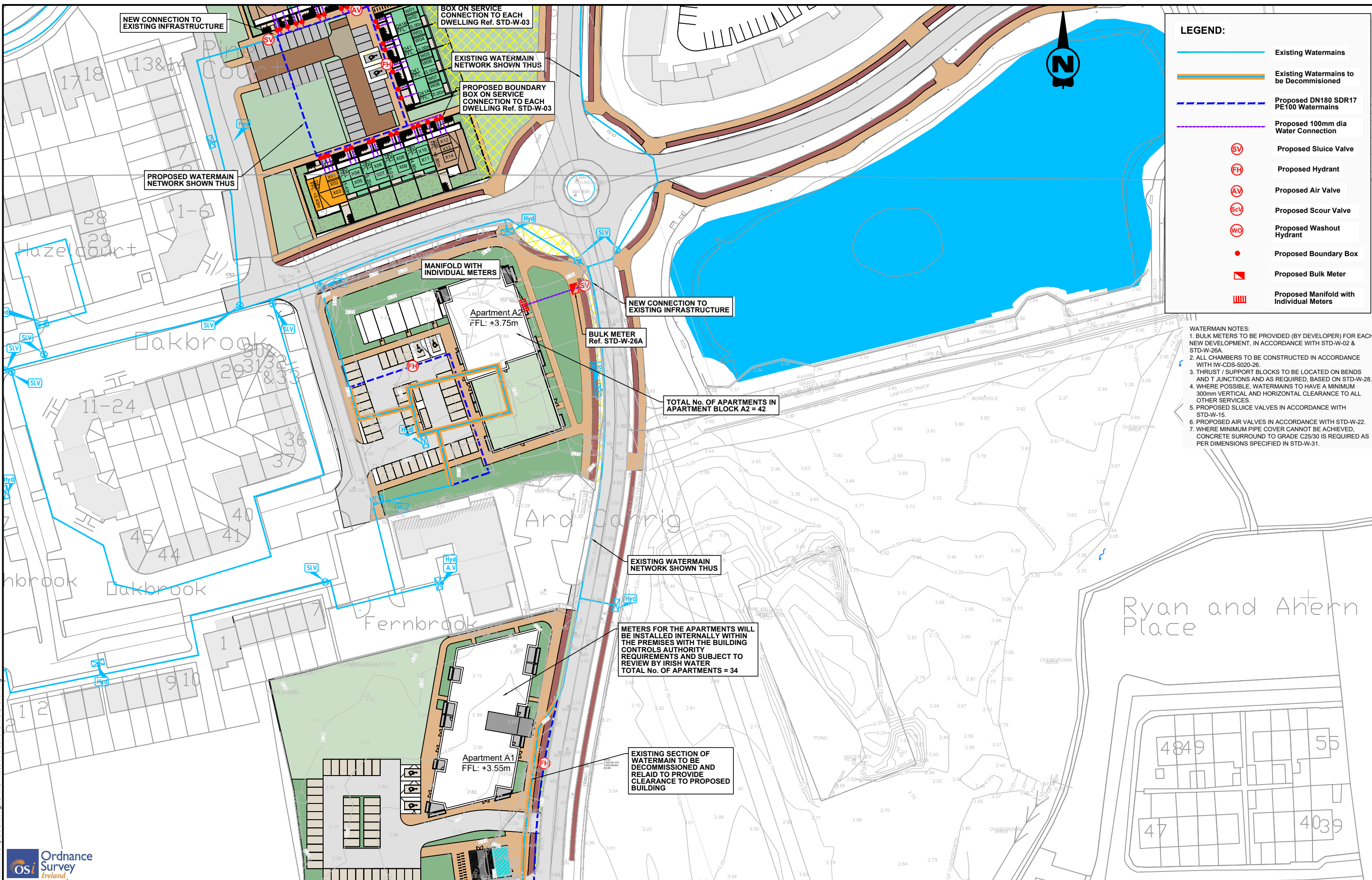

LEGEND:

- Existing Watermains
- Existing Watermains to be Decommissioned
- Proposed DN180 SDR17 PE100 Watermains
- Proposed 100mm dia Water Connection
- SV Proposed Sluice Valve
- FH Proposed Hydrant
- AV Proposed Air Valve
- ScV Proposed Scour Valve
- WO Proposed Washout Hydrant
- Proposed Boundary Box
- Proposed Bulk Meter
- ▨ Proposed Manifold with Individual Meters

WATERMAIN NOTES:

1. BULK METERS TO BE PROVIDED (BY DEVELOPER) FOR EACH NEW DEVELOPMENT, IN ACCORDANCE WITH STD-W-02 & STD-W-26A.
2. ALL CHAMBERS TO BE CONSTRUCTED IN ACCORDANCE WITH IW-CDS-5020-26.
3. THRUST / SUPPORT BLOCKS TO BE LOCATED ON BENDS AND T JUNCTIONS AND AS REQUIRED, BASED ON STD-W-28.
4. WHERE POSSIBLE, WATERMAINS TO HAVE A MINIMUM 300mm VERTICAL AND HORIZONTAL CLEARANCE TO ALL OTHER SERVICES.
5. PROPOSED SLUICE VALVES IN ACCORDANCE WITH STD-W-15.
6. PROPOSED AIR VALVES IN ACCORDANCE WITH STD-W-22.
7. WHERE MINIMUM PIPE COVER CANNOT BE ACHIEVED, CONCRETE SURROUND TO GRADE C25/30 IS REQUIRED AS PER DIMENSIONS SPECIFIED IN STD-W-31.

NEW CONNECTION TO EXISTING INFRASTRUCTURE

BOX ON SERVICE CONNECTION TO EACH DWELLING Ref. STD-W-03

EXISTING WATERMAIN NETWORK SHOWN THUS

PROPOSED BOUNDARY BOX ON SERVICE CONNECTION TO EACH DWELLING Ref. STD-W-03

PROPOSED WATERMAIN NETWORK SHOWN THUS

MANIFOLD WITH INDIVIDUAL METERS

Apartment A2
FFL: +3.75m

NEW CONNECTION TO EXISTING INFRASTRUCTURE

BULK METER
Ref. STD-W-26A

TOTAL No. OF APARTMENTS IN APARTMENT BLOCK A2 = 42

EXISTING WATERMAIN NETWORK SHOWN THUS

METERS FOR THE APARTMENTS WILL BE INSTALLED INTERNALLY WITHIN THE PREMISES WITH THE BUILDING CONTROLS AUTHORITY REQUIREMENTS AND SUBJECT TO REVIEW BY IRISH WATER
TOTAL No. OF APARTMENTS = 34

EXISTING SECTION OF WATERMAIN TO BE DECOMMISSIONED AND RELAID TO PROVIDE CLEARANCE TO PROPOSED BUILDING

General Notes

(i) Hard copies, dwf and pdf will form a controlled issue of the drawing. All other formats (dwg etc.) are deemed to be an uncontrolled issue and any work carried out based on these files is at the recipient's own risk. RPS will not accept any responsibility for any errors from the use of these files, either by human error by the recipient, listing of the un-dimensioned measurements, compatibility with the recipient's software, and any errors arising when these files are used to aid the recipient's drawing production, or setting out on site.

(ii) DO NOT SCALE, use figured dimensions only.

(iii) This drawing is the property of RPS, it is a project confidential classified document. It must not be copied used or its contents divulged without prior written consent. The needs and expectations of client and RPS must be considered when working with this drawing.

(iv) Information including topographical survey, geotechnical investigation and utility detail used in the design have been provided by others.

(v) All Levels refer to Ordnance Survey Datum, Main Head.

Rev	Date	Dim Ck	Amendment / Issue	App
S4 P01	08/06/22		Issued for Planning	
S3 P03	08/06/22		Issue for Review and Comment	
P01	26/10/21		Pre-Application Submission	

Model File Identifier
MCW1088-RPS-00-XX-DR-C-UT0101

Scale	1:500 @ A1 1:1000 @ A3	Project	Castlelake SHD
Created on	03/09/2021	Title	Proposed Watermain Infrastructure Watermain Layout (7 of 8)
Sheets	08 of 09	File Identifier	MCW1088-RPS-00-XX-DR-C-UT0101-08
Rev	S4	Status	P01

R:\MCW1088 - BAM Castlelake Residential Dwg\8.0 Drawings\UT\MCW1088-RPS-00-XX-DR-C-UT0101.dwg

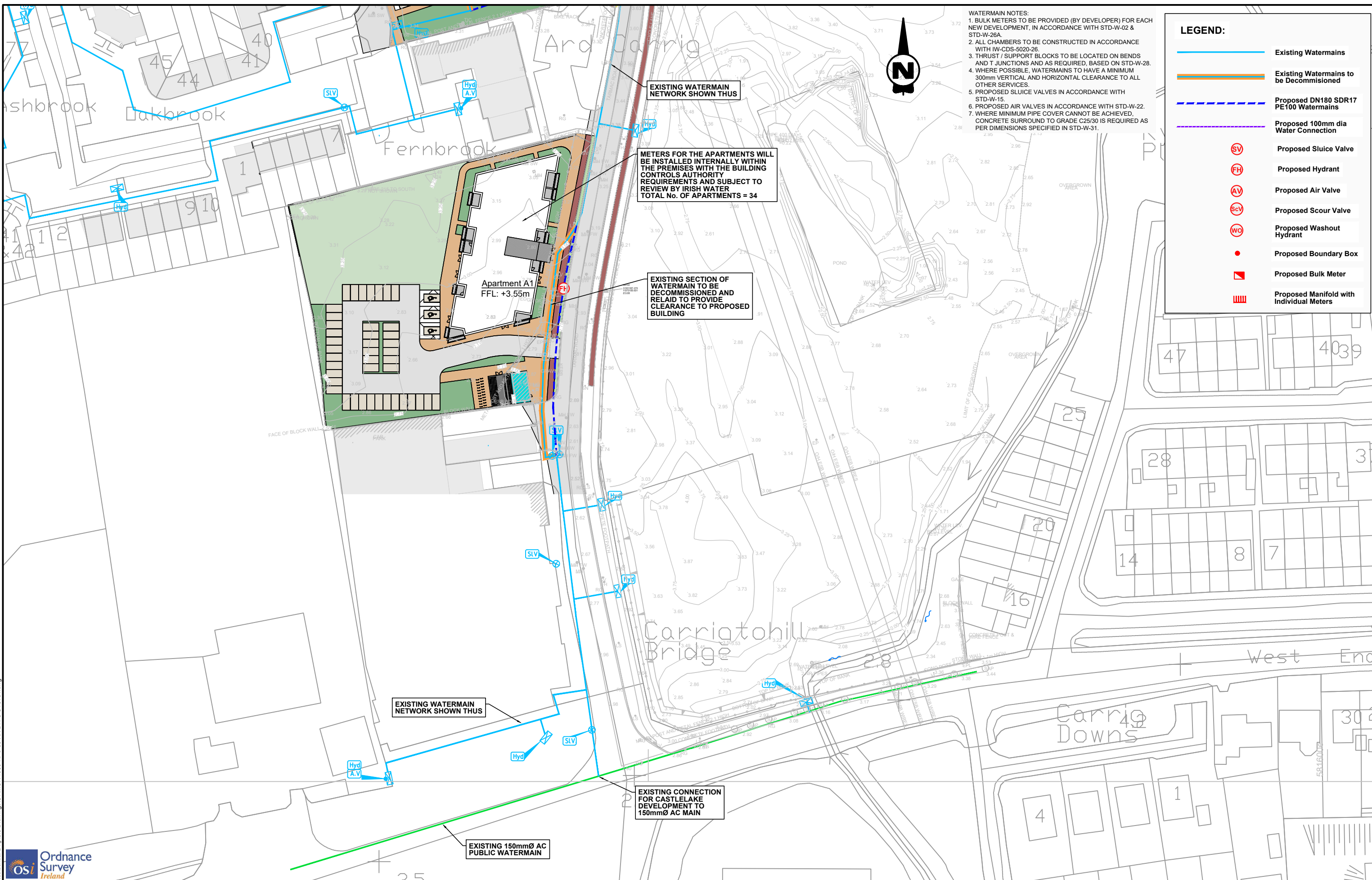

- WATERMAIN NOTES:**
1. BULK METERS TO BE PROVIDED (BY DEVELOPER) FOR EACH NEW DEVELOPMENT, IN ACCORDANCE WITH STD-W-02 & STD-W-26A.
 2. ALL CHAMBERS TO BE CONSTRUCTED IN ACCORDANCE WITH IW-CDS-5020-26.
 3. THRUST / SUPPORT BLOCKS TO BE LOCATED ON BENDS AND T JUNCTIONS AND AS REQUIRED, BASED ON STD-W-28.
 4. WHERE POSSIBLE, WATERMAINS TO HAVE A MINIMUM 300mm VERTICAL AND HORIZONTAL CLEARANCE TO ALL OTHER SERVICES.
 5. PROPOSED SLUICE VALVES IN ACCORDANCE WITH STD-W-15.
 6. PROPOSED AIR VALVES IN ACCORDANCE WITH STD-W-22.
 7. WHERE MINIMUM PIPE COVER CANNOT BE ACHIEVED, CONCRETE SURROUND TO GRADE C25/30 IS REQUIRED AS PER DIMENSIONS SPECIFIED IN STD-W-31.

LEGEND:

- Existing Watermains
- Existing Watermains to be Decommissioned
- Proposed DN180 SDR17 PE100 Watermains
- Proposed 100mm dia Water Connection
- SV Proposed Sluice Valve
- FH Proposed Hydrant
- AV Proposed Air Valve
- ScV Proposed Scour Valve
- WC Proposed Washout Hydrant
- Proposed Boundary Box
- Proposed Bulk Meter
- ▨ Proposed Manifold with Individual Meters

Client



General Notes

(i) Hard copies, dwf and pdf will form a controlled issue of the drawing. All other formats (dwg etc.) are deemed to be an uncontrolled issue and any work carried out based on these files is at the recipient's own risk. RPS will not accept any responsibility for any errors from the use of these files, either by human error by the recipient, listing of the un-dimensioned measurements, compatibility with the recipient's software, and any errors arising when these files are used to aid the recipient's drawing production, or setting out on site.

(ii) DO NOT SCALE, use figured dimensions only.

(iii) This drawing is the property of RPS, it is a project confidential classified document. It must not be copied used or its contents divulged without prior written consent. The needs and expectations of client and RPS must be considered when working with this drawing.

(iv) Information including topographical survey, geotechnical investigation and utility detail used in the design have been provided by others.

(v) All Levels refer to Ordnance Survey Datum, Main Head.

Rev	Date	Drawn	Checked	Amendment / Issue	App
S4 P01	08/06/22	[Signature]	[Signature]	Issued for Planning	[Signature]
S3 P03	08/06/22	[Signature]	[Signature]	Issue for Review and Comment	[Signature]
P01	26/10/21	[Signature]	[Signature]	Pre-Application Submission	[Signature]



Scale: 1:500 @ A1
1:1000 @ A3

Created on: 13/09/2021

Sheets: 09 of 09

Project: Castlelake SHD

Title: Proposed Watermain Infrastructure Watermain Layout (8 of 8)

Model File Identifier: MCW1088-RPS-00-XX-DR-C-UT0101

File Identifier: MCW1088-RPS-00-XX-DR-C-UT0101-09

Status: S4

Rev: P01

R:\MCW1088 - BAM Castlelake Residential Dwg\8.0 Drawings\UT\MCW1088-RPS-00-XX-DR-C-UT0101.dwg